

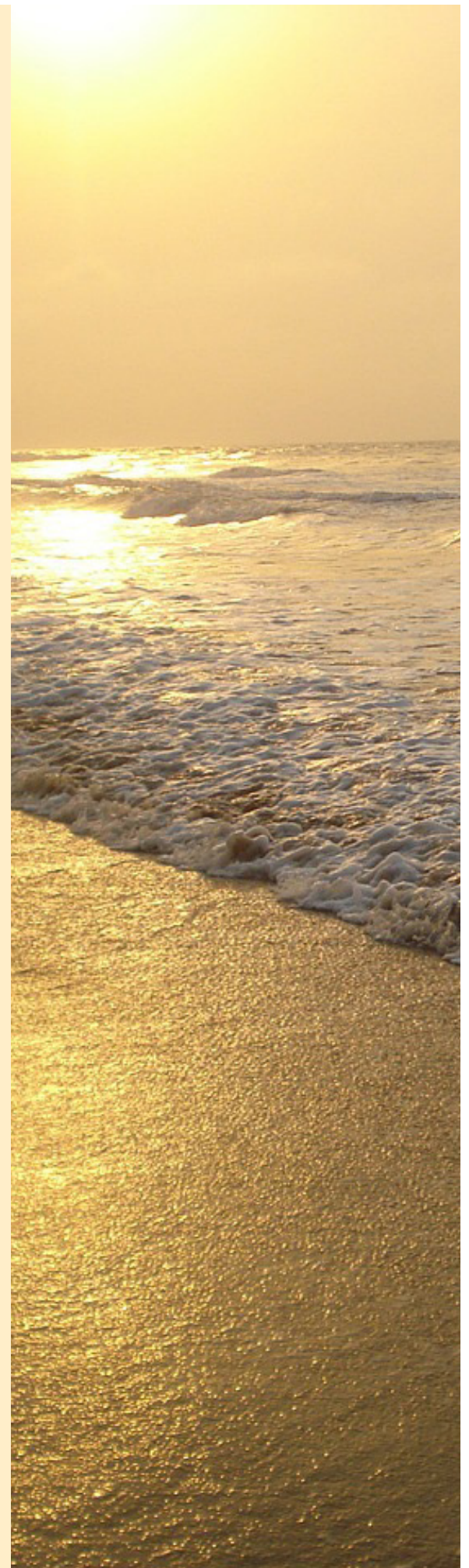

Shelter Island, San Diego, California

*B*ury your toes in the sand. Catch a wave. Board a scenic harbor cruise, take in a museum or visit one of San Diego's world-renowned attractions. On Southern California's sun-drenched coast, San Diego is a land of eternal summer and unending adventure. Best known for its near perfect climate and incomparable sandy beaches that stretch for 70 miles along the Pacific Ocean, San Diego is America's Finest City. And one of the finest retreats the city has to offer is Humphreys Half Moon Inn & Suites. Framed by the famous America's Cup Harbor, San Diego Bay and a colorful marina, Humphreys is without a doubt genuinely San Diego.





Accommodations

Complemented by arching palms and gentle ponds are Humphreys 182 beautifully appointed guest rooms and suites. Varying in size from 450 to 1,050 square feet, Humphreys suites offer either a wetbar or full-size kitchen with separate living area. Many of the accommodations offer patios or balconies with stunning views of our private marina, picturesque San Diego Bay and the dramatic city skyline. As you wander through our inviting gardens scented with tropical flowers and accented with the musical splashing of a waterfall, you'll soon wonder if you've found paradise. All of the amenities that you would find at a luxury resort are offered at Humphreys Half Moon Inn & Suites. Thoughtful conveniences include wireless high-speed Internet access, refrigerators, microwave ovens, coffee makers, hairdryers, irons and boards.





Amenities

In this sunny playground, you'll find unlimited fun and unrivaled hospitality at Humphreys Half Moon Inn & Suites. Work out the kinks in our fitness center. Relax by our large heated pool. Unwind in the bubbling spa, or sip your favorite cocktail at our poolside bar. On our putting green, guests can test their skills at a game of croquet or try their hand at table tennis. The recreational activities are abundant and so is the sunshine. Whether you take an afternoon bicycle ride around Shelter Island or enjoy the scenic threemile walking/jogging path along San Diego Bay, you'll have the time of your life. Exemplary guest services include concierge assistance, daily room service and valet.





Restaurant

*H*umphreys waterfront restaurant is consistently rated among the best in San Diego. Best Food. Best View. Best Music. Best Wine List. Our award-winning chef presents Modern Global Cuisine – featuring influences from around the world including Asian, French, American and more. Humphreys' Sunday Champagne Brunch is an experience not to be missed – incredibly beautiful buffet tables laden with dozens and dozens of delicious entrees and decadent desserts. These spectacular dining experiences are enhanced by the breathtaking views of sailboats anchored in our marina, sunsets, and city lights sparkling across San Diego Bay.





Backstage Live

Wrap up the evening with a nightcap or take a spin around the dance floor. Next door is Humphreys intimate lounge, voted “San Diego’s Best Live Music Club.” In addition to offering great happy hours with live entertainment, Backstage Live showcases some of Southern California’s best dance, R&B and jazz bands.





Meetings

With so many intriguing options for meetings and banquets along with the finely tuned services of a specially trained conference staff, it's no wonder why Humphreys has earned San Diego's Finest Service Award. Inspiring views from our waterfront banquet and meeting rooms provide an unforgettable setting for your event – whether it's a daytime meeting, an executive retreat or an evening social function. With flexible meeting space including a variety of break-out rooms, state-of-the-art audio visual equipment and an expert staff, your meeting is certain to be a resounding success.

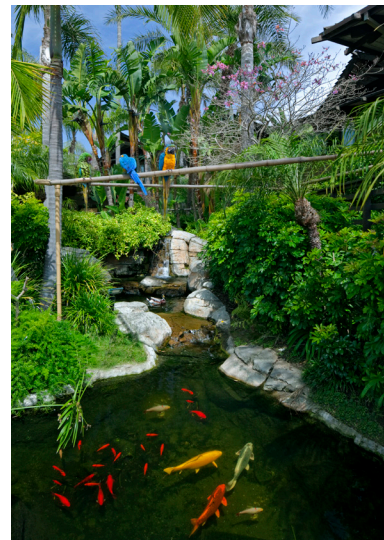

Banquets and Weddings

San Diego's mild climate and our beautiful location on the water create the perfect setting for both indoor and outdoor events. Whether you are planning an intimate garden wedding or a grand corporate reception, we offer a variety of awe inspiring options to accommodate groups of 30-1000. Either way, our specially trained staff will work with you to create just the right ambiance, tantalizing cuisine and those special touches that make a truly memorable celebration.



Concerts/Special Events

There's nothing like Humphreys Concerts By the Bay! Nationally renowned, this concert series held every May through October showcases some of the greatest entertainers in the world right here in the outdoor concert venue at Humphreys Half Moon Inn & Suites. Stevie Wonder, Ringo Starr, Steely Dan and Jewel are but a few of the stars who have appeared in concert on this phenomenal stage. Humphreys open air facility can also bring a new dimension to your meeting plans. We'll transform this picturesque bayside setting with permanent stage and state-of-the-art sound and lighting systems into the perfect backdrop for corporate parties, VIP receptions, theme banquets, private concerts and much more.

Imagine the possibilities!

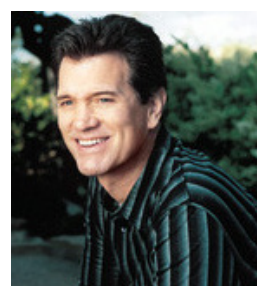

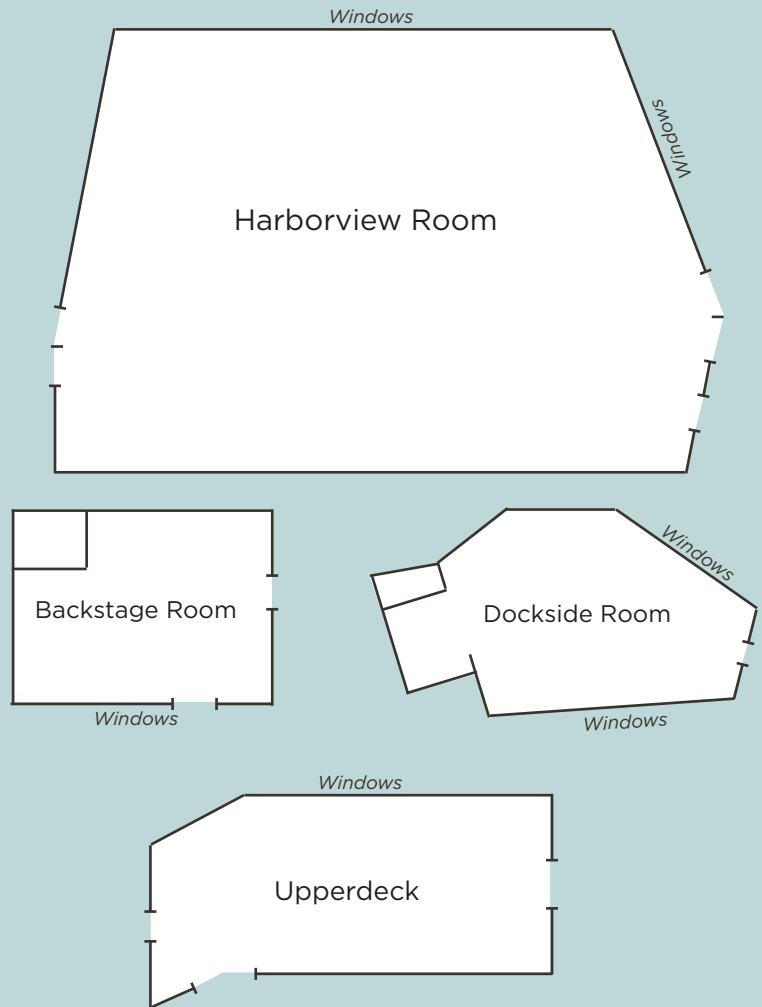
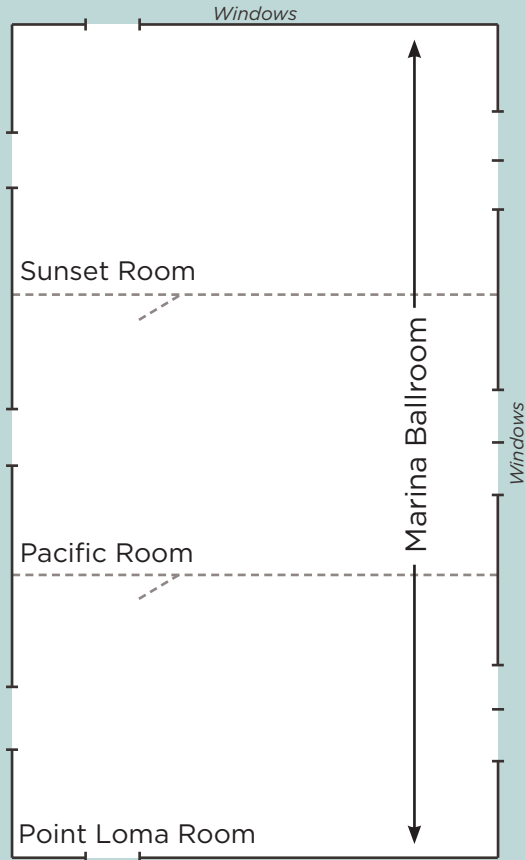

BANQUET & CONFERENCE ROOM CAPACITIES

**Capacities may vary based on other set up requirements*

| Area | Square Feet | Dimensions | Theater | Class Room | U-Shape | Banquet Rounds | Cocktail Reception | Conf. Style |
|---------------------------|-------------|------------|---------|------------|---------|----------------|--------------------|-------------|
| <i>Indoor Facilities</i> | | | | | | | | |
| Marina Ballroom | 2,028 | 39'x52' | 200 | 100 | 60 | 150 | 200 | 60 |
| Sunset | 663 | 17'x39' | 60 | 30 | 30 | 30 | 75 | 25 |
| Pacific | 663 | 17'x39' | 60 | 30 | 30 | 30 | 75 | 25 |
| Point Loma | 663 | 17'x39' | 60 | 30 | 30 | 30 | 75 | 25 |
| Harborview | 1,280 | 40'x32' | 100 | 60 | 35 | 80 | 100 | 35 |
| Backstage | 448 | 28'x16' | 40 | 20 | 15 | 40 | 50 | 20 |
| Dockside | 435 | 19'x22' | 30 | 20 | 18 | 40 | 40 | 20 |
| Upperdeck | 1,248 | 26'x48' | - | - | - | 50 | - | - |
| <i>Outdoor Facilities</i> | | | | | | | | |
| Concert Lawn | 10,000 | 100'x100' | 1,350 | - | - | 400 | 1,000 | - |
| The Green | 5,500 | - | 220 | - | - | - | 200 | - |

CONCERT LAWN

Marina

Stage

Pond

110'

100'

Open Space (10,000 square feet)

Marina Ballroom

HUMPHREYS
CONCERTS
by the bay

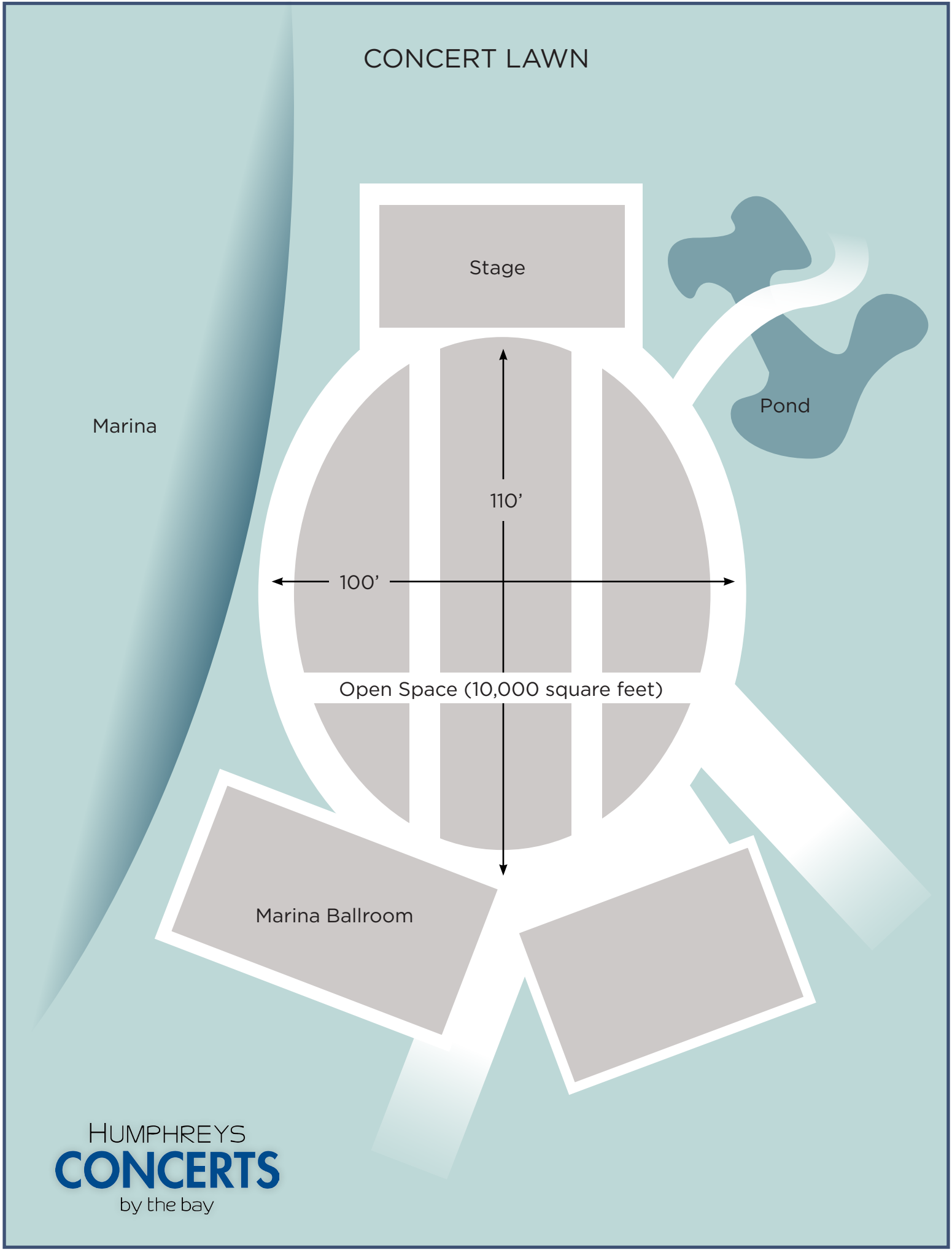





2303 Shelter Island Drive
San Diego, California 92106
619.224.3411
Fax 619.224.3478
Sales 800.377.1177
Sales Fax 619.224.9179
halfmooninn.com
e-mail: sales@halfmooninn.com
catering@halfmooninn.com